

## GW-105-110-115

### STANDARD SERIES PHOTOCONTROL Extreme Long Life



#### OVERVIEW

Gateway International 360's standard photocontrols are designed for the demands of HID and solid-state lighting (SSL), making them an excellent choice for LED, conventional & electronic HID, and Induction luminaires.

#### APPLICATIONS

- LED luminaires that require dusk to dawn control
- Luminaires that use solid state ballasts/drivers (e.g. CFL, Induction, Electronic HID)
- LED, HID, Induction, Fluorescent Systems, Roadways, Street Lighting, Parking Lots and Security Lighting

#### FEATURES

- IR filter Silicon Light Sensor, sensitive to sunlight, but not to LED or other sources of infrared light
- FR4 fiberglass printed circuit board
- Sealed relay
- Surge protection: 1 - 430 Joule MOVs / 10,000 amps each, Total Joules 430, 10,000 AMPS or 2-430 Joule MOVs/ 10,000 amps each, Total Joules 860
- Silicon gasket has a continuous use temperature of 105° C
- Turn off delay: 2-5 seconds
- Dark green cover standard -- Other colors optional
- IP54, optional IP65
- Zero-crossing detection
- Turn ON 0.5-1.1fc and turn OFF at 2.6-3.3fc.
- **10 year one-for-one replacement warranty - labor not included**

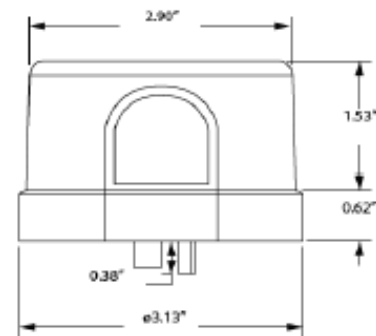

#### SPECIFICATIONS

- Meets or exceeds ANSI C136.10 and surge rate as to C136.10 and UL733
- ROHS compliant
- Manufactured in an ISO certified facility

#### OPERATING CHARACTERISTICS

- Voltage 105 to 305 VAC, 60Hz for 105, 208, 277 VAC Systems
- Load rating: 1800VA driver or 1000W ballast load, 20A
- Temperature: -40 to +70° ambient
- Will operate down to 85VAC
- 30,000 working hours, 10,000 on/off cycles

9/18/2018

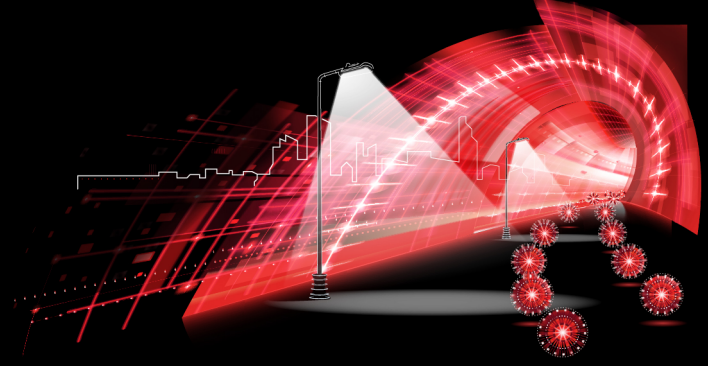

#### Order Guide:

**GW-105BU-10:** 105-305 VAC 430J MOV, 10,000-amp surge. Blue cover (BU) or Green cover (GN)

**GW-110BR-10:** 105-305 VAC 430J MOV, 10,000-amp surge. Brown cover.

**GW-115BK-10:** 105-305 VAC 430J MOV, 10,000-amp surge. 2-5 second delay turn off. Black cover.

**GW-105GN-10:** 105-305 VAC 430J MOV, 10,000-amp surge. Dark green cover.

**GW-105BU-20:** 105-305 VAC 860J MOV, 10,000-amp surge. Blue cover (BU) or Green cover (GN)

**GW-110BR-20:** 105-305 VAC 860J MOV, 10,000-amp surge. Brown cover.

**GW-115BK-20:** 105-305 VAC 860J MOV, 10,000-amp surge. 2-5 second delay turn off. Black cover.

**GW-105GN-20:** 105-305 VAC 860J MOV, 10,000-amp surge. Dark green cover.

**TURN ON LEVEL:** -1.0 Energy Saver, 1.5 ANSI std, 2.6 IES recommendation, 8.0 Metro-High Ambient. Sample: GW-105-1.5BK-10

**Optional colors based on customer requirements.**

#### Specifications for Standard Photocontrol Model GW-105BU-10, Multi-Volt, RoHS compliant, Standard Photocontrol

- 1) Photocontrol: Shall be a locking type (aka twist lock) and meet or exceed all requirements of ANSI C136.10 except as noted below.
- 2) UL: For standard photocontrols, UL versions will be available with a blue cover. Non-UL versions are available in black or as specified by customer.
- 3) Line voltage: 105-305 VAC @ 50/60 hertz, Up to 200 amps inrush.
- 4) Load rating: Shall be at least 1800VA. Control must be able to operate incandescent, ballast, LED and lighting-contractor-type loads.
- 5) Control relay: Shall be sealed.
- 6) Turn ON 0.5-1.1fc and turn OFF at 2.6-3.3fc.
- 7) Photo sensor: Sealed silicon sensor. Cadmium sulfide cells are not acceptable.
- 8) Failure mode: Control will fail ON per ANSI definition. Relay must use normally closed contacts.
- 9) Time delay: Control must have instant ON and 2-5 seconds OFF delay.
- 10) Surge protection: Shall be in the form of a Metal Oxide Varistor (MOV) wired line to neutral. MOV shall be rated a minimum of 430 joules and 10,000-amp surge each. Finished control shall not fail when subjected to 5 surges of 10,000 amps applied at 1-minute intervals. Surge wave form as described in ANSI C136.10-2017 section on High Surge.
- 11) Housing: Shall be blue, opaque (other colors optional-green) and of an impact- and UV-resistant material. Impact resistance of housing shall be greater than 1.0 ft./lbs. at -20°C. Top of cover 0.070 inch (1.78 mm) thick.
- 12) Drop test: Control must withstand a drop of 3 feet to a concrete floor without causing damage to the housing or changing electrical operation.
- 13) Markings: The following must appear on the control: month/year of manufacture, individual serial numbers, model description, operating voltage range and load rating.
- 14) Power consumption: Shall consume 0.5 watts or less at 120VAC.
- 15) Environmental: Shall be RoHS compliant. It shall not contain lead, cadmium, mercury or hexavalent chromium. Pigments in plastic parts shall not contain bromine compounds or heavy metal pigments.
- 16) **Warranty: 10 years (one-for-one control replacement, labor not included), 10,000 working hours total of 33,000 cycles on/off.**
- 17) Quality: Control manufacturer must be ISO or similar certified.

**WARRANTY** All photocontrols are marked with date of manufacture. This product is warrantied to operate within its original specifications and shall be free of electrical or mechanical defects. Consult factory for the warranty time. Manufacturer's warranty shall be limited to providing a replacement control of same type and shall not cover costs of removal, replacement, loss of service, nor any consequential damages. This warranty is in lieu of and excludes all other warranties either expressed or implied. Full warranty statement is available by consulting factory.